

AA - SECTION THROUGH RADCLIFFE CAMERA SHOWING PROPOSED OFFICE SPACE TO UPPER CAMERA, 1:200



BB - LONGITUDINAL SECTION SHOWING PROPOSED ACCESS AND EXISTING ENTRANCE

Background

The Bodleian Libraries of the University of Oxford form the largest university library system in the United Kingdom. They include the Bodleian Library, which has been a library of legal deposit for 400 years, major research libraries, and libraries attached to faculties, departments and other institutions of the University. The combined library collections number more than 11 million printed items, in addition to 30,000 e-journals and vast quantities of materials in other formats. For additional information see www.bodleian.ox.ac.uk.

The iconic buildings that make up the Bodleian Library complement the renown of its collections and contribute to the standing of the University as a major centre for research, learning and culture. The many thousands of scholars and members of the public who visit the Bodleian Library each year make a significant contribution to the economic health of the city of Oxford and the surrounding region.

These historic buildings provide the library with some of its most popular reading rooms; however, they also impose operational limitations on the library. In order to maintain the usefulness and popularity of these buildings throughout the 21st Century, Purcell (known then as Purcell Miller Tritton) worked with the Bodleian Libraries to convert the existing Underground Bookstore beneath Radcliffe Square into an open-access library. This allowed for direct access to material and for improved library facilities whilst responding to the library's administrative needs for reducing deliveries to and from the Book Storage Facility.

The final phase of the current project was held over from last year and can now benefit from some further detailed consideration and can be informed by a subsequent proposal to transfer the History Faculty Library to the Radcliffe Camera and Gladstone Link.

Purcell have been appointed once again by the University of Oxford to help facilitate the design of minor alterations to the Radcliffe Camera and Old Bodleian Library. These are as follows:

- **New Improved Access to Lower Camera**
The University of Oxford wish to make the Camera more accessible to all by providing inclusive access from Radcliffe Square.
- **Improvements to the Library Services within the Upper Camera**
Subtle alterations in the Upper Camera to include a self-contained Librarian work space and a consultation room which will address a long history of complaints about even low noise travelling around the space.
- **Configuration of services and furniture layouts within the Old Bodleian Library**
Purcell have worked closely with user group representatives to put forward a new layout which aims to address the needs of Readers in providing a more effective working environment.

Purcell have a long established relationship with the University. Through their work on the Underground Bookstore the practice have obtained an extensive knowledge and appreciation for the Bodleian Library and its associated buildings. The proposed scheme aims to enhance and improve upon the functionality of the existing working environment whilst also remaining sympathetic to this unique and very special building.

Radcliffe Camera

Built between 1737 and 1749, the Radcliffe Camera is one of Oxford's most recognised buildings. Today the Radcliffe Camera holds books from English, History and Theology collections and continues to provide an inviting learning atmosphere to readers and students attending the University.

Phases of the Underground Bookstore project saw the installation of a lift for wheelchairs users and a comfortable staircase for ambulant readers to provide access to and exit from the Gladstone Link. However, a limitation remained that people with restricted mobility were only able to use the Lower Camera as an emergency exit route. The current proposals build on these improvements by reconfiguring one of the original access points to the Lower Camera as a fully compliant level entrance/exit route to the Lower Camera reading room allowing full access. This also gives us the opportunity to install a totally functional entrance and exit control system providing book security at this access point. The new entrance will provide a serviced reception and enquiry point for readers and will allow the removal of the metal platform in the staircase. The existing staff area in Bay 2 will be reduced as most of its functions will transfer to the new reception/service point; the space freed up will provide additional reader seats as we are aiming to maintain the existing capacity.

The existing librarian workstation and service point on the Upper Camera is not efficient and does not allow conversation between readers and librarians without causing disturbance due to necessity of silence in this space. The proposed librarian's office provides:

- Acoustic separation between areas to allow staff communication
- Visual connectivity and invigilation between library areas. Readers will be fully aware of the services provided
- Consultation space to allow conversation, inductions and group study.

Transferring the History Faculty Library

The Bodleian Libraries are committed to maintaining the Old Bodleian Library and Radcliffe Camera as a modern working library rather than allowing it and its services to become obsolete, or vacating the buildings entirely and allowing them to be given over to other uses for which they were not originally intended. Because of changing patterns of use and informed by their Academic Strategy and associated estates strategy the Bodleian Libraries have already refurbished the Underground Bookstore and opened it to readers as the Gladstone Link. This has given rise to the opportunity to transfer the lending collections and subject support services of the current History Faculty Library so that they can join other provision for History already situated in the Old Library and Radcliffe Camera. This consolidation allows us to improve services to scholars and students of History.

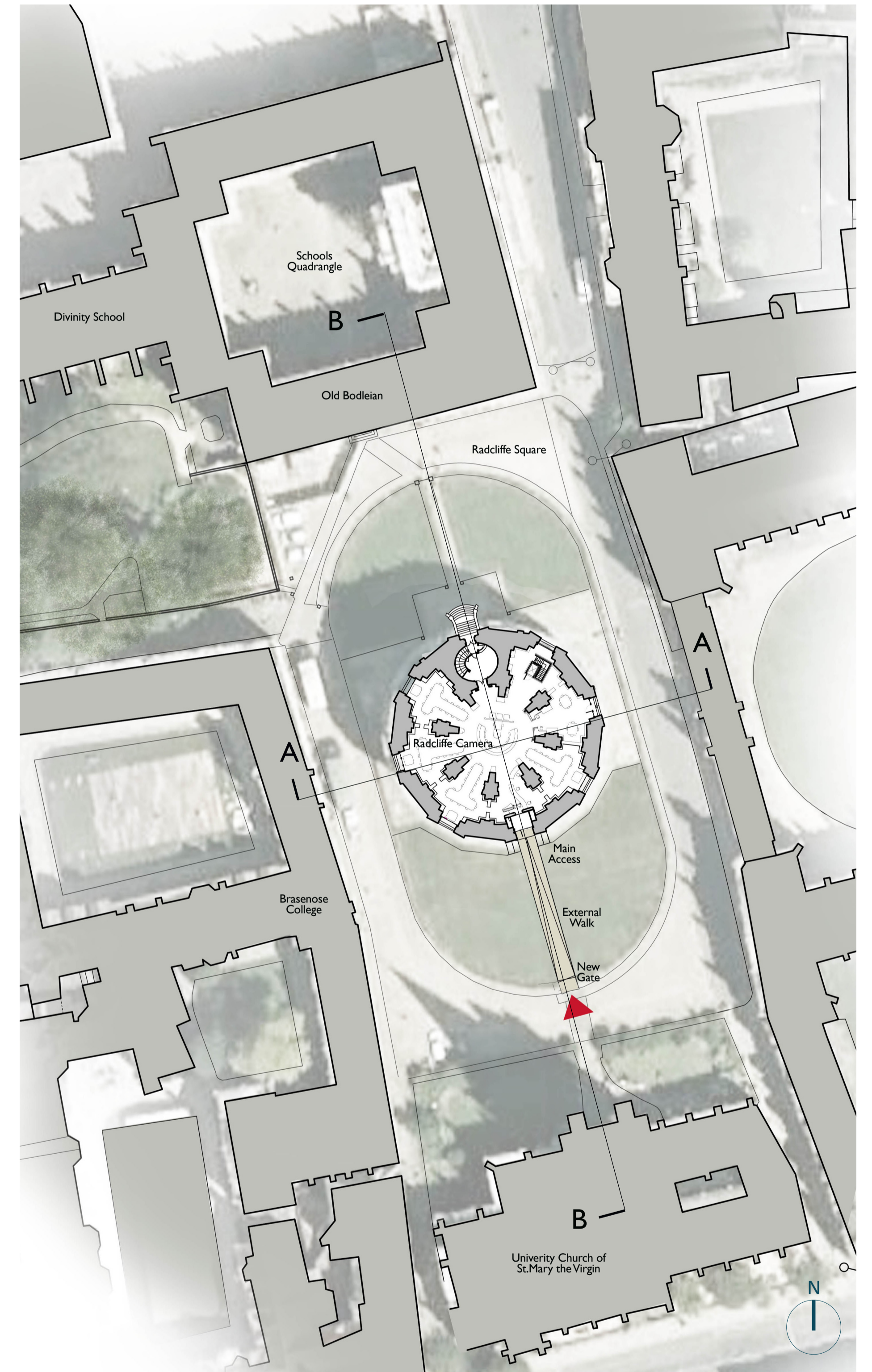

SITE PLAN 1:500

THE RADCLIFFE CAMERA



EXISTING

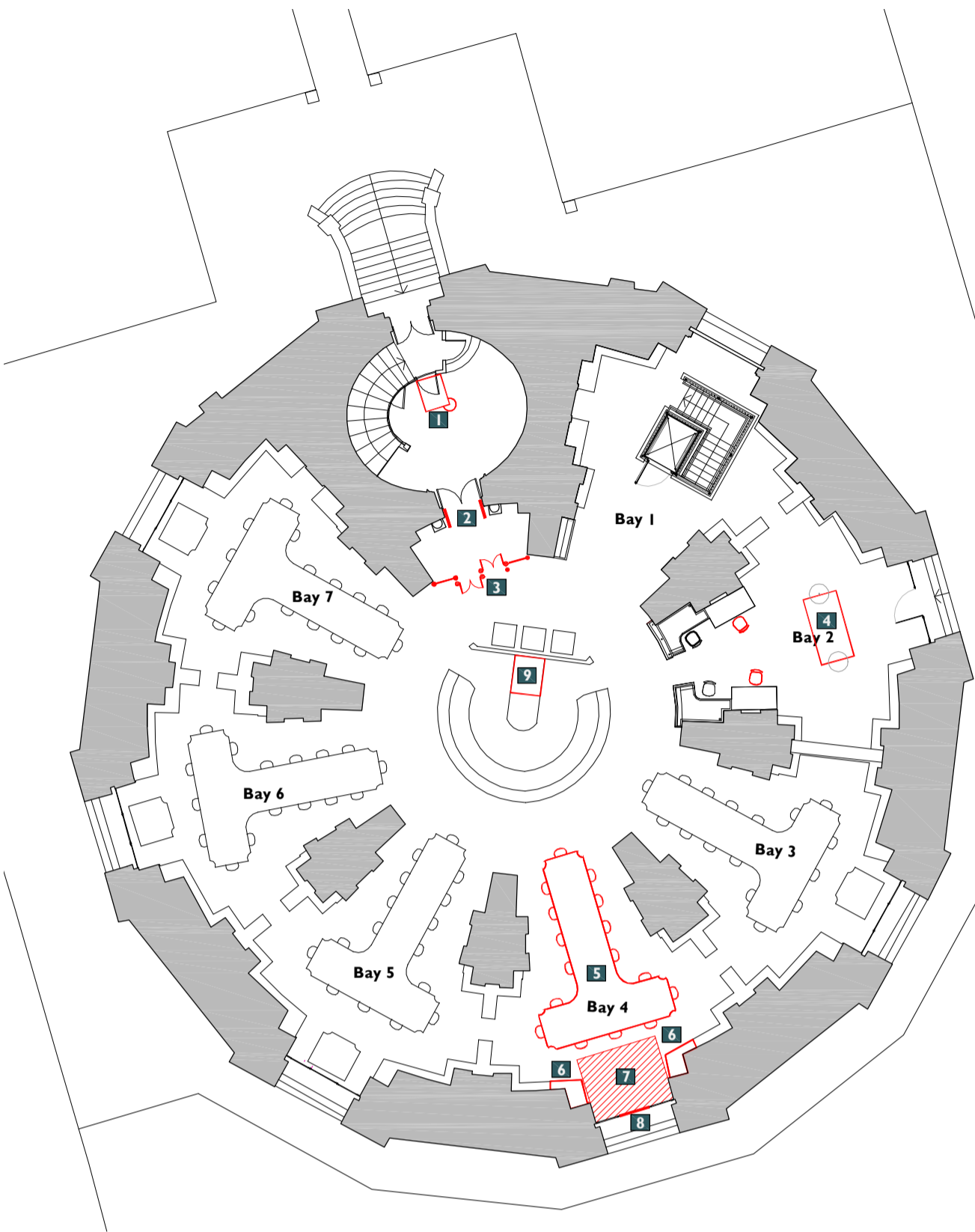

Removals / Alterations

- 1 Porter's desk
- 2 Book detectors
- 3 Speed gate
- 4 Collating table
- 5 Study desks
- 6 Bookshelves
- 7 Raised floor
- 8 Centre window panel
- 9 Standing height counter

Existing Reader's Seats = 86

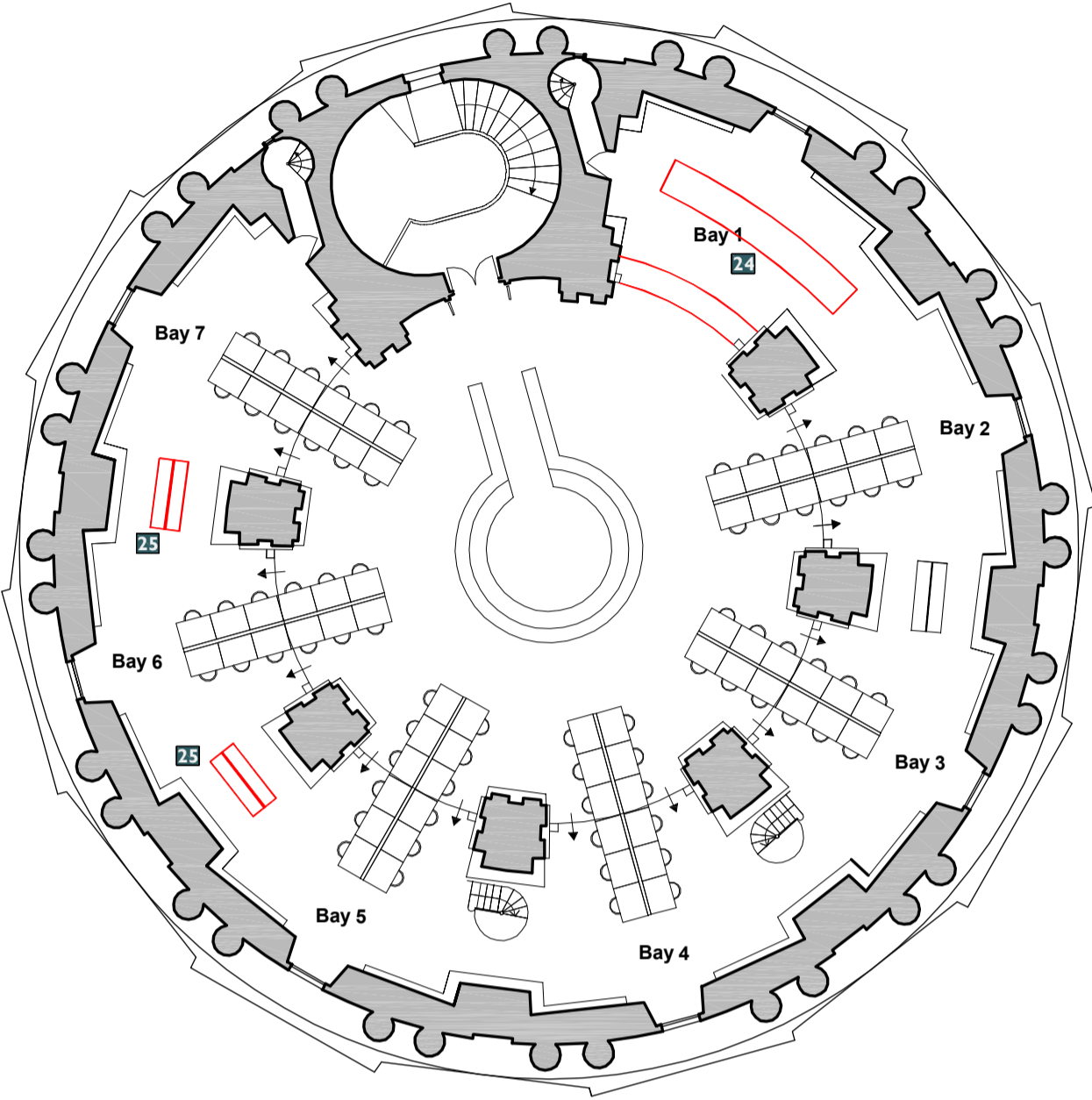

Removals / Alterations

- 24 Removal of existing central bookcases and librarian desk
- 25 Low bookshelves to be replaced

Existing Reader's Seats = 60

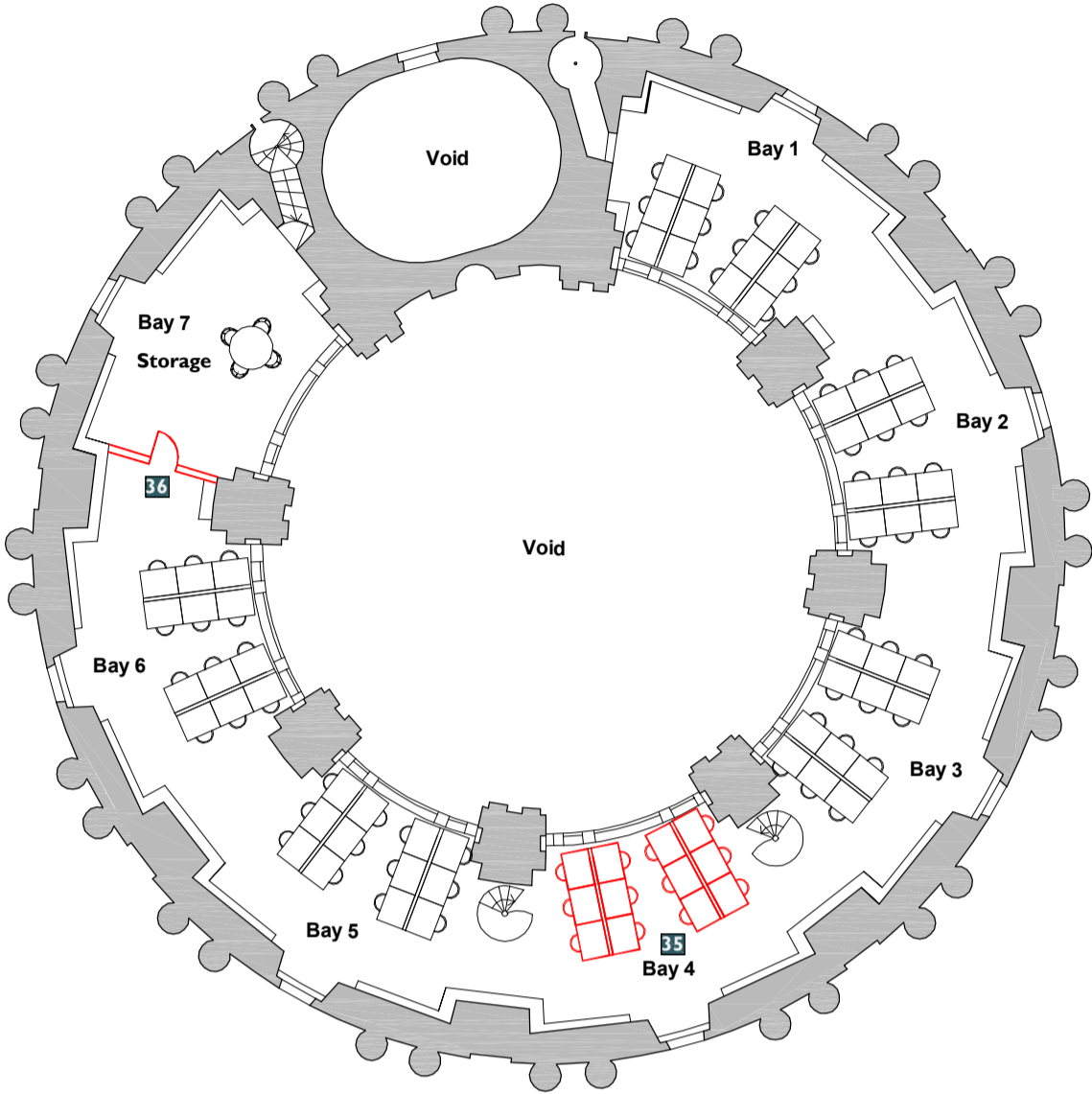

Removals / Alterations

- 33 Move desks from Bay 4 to Bay 7
- 34 Partition to be removed

Existing Reader's Seats = 72

LOWER CAMERA

UPPER CAMERA

UPPER GALLERY

PROPOSED

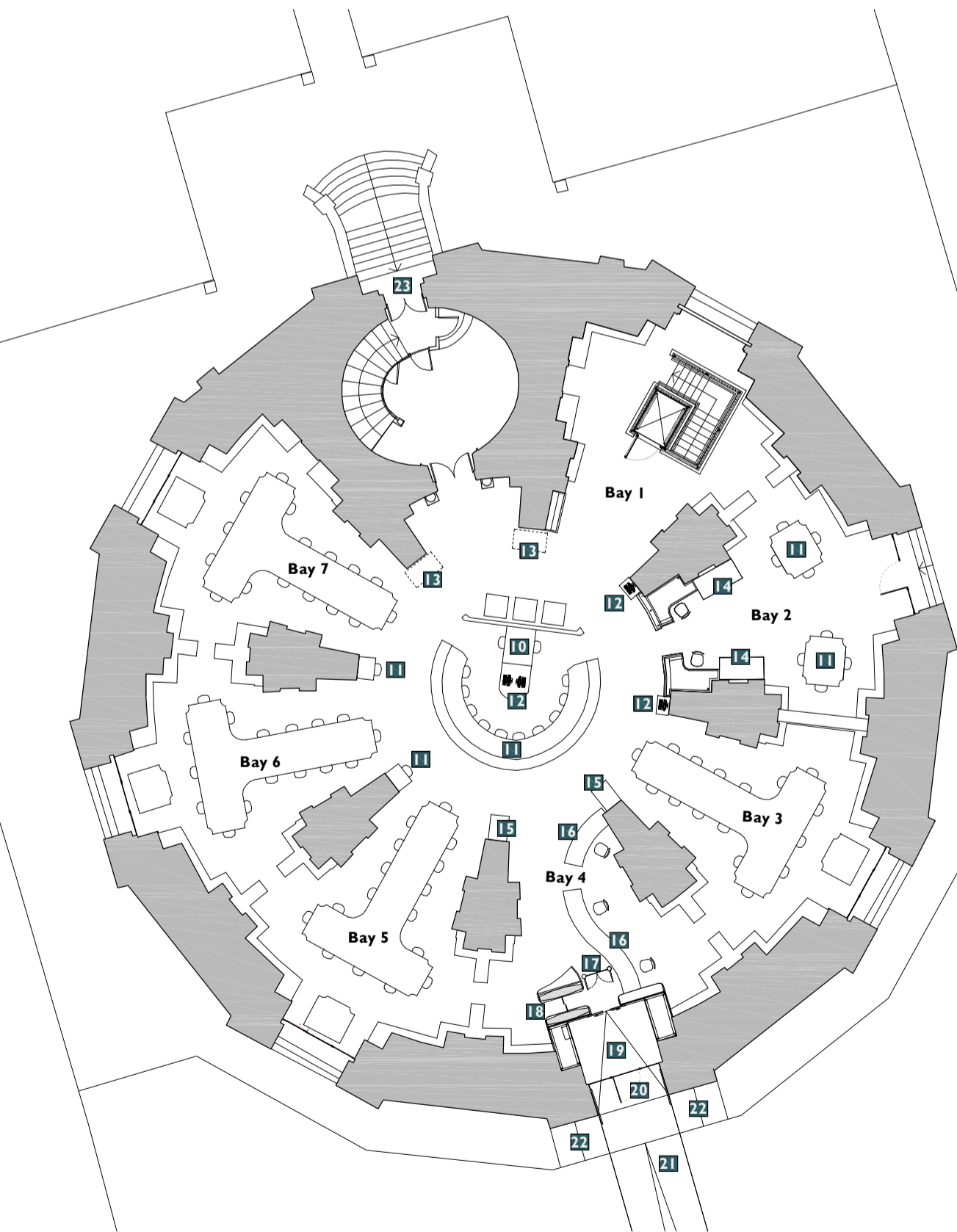

Proposed works

- 10 Surface lowered to accommodate 2 no. reader desks
- 11 New readers desks
- 12 Look up terminals
- 13 Trolley parking
- 14 Collating tables
- 15 Self issue machines
- 16 Librarian's desks
- 17 Speed gate for exit & disabled access
- 18 Entrance speed stile encased in bookshelf & display case
- 19 Drusage lobby formed by display cases with glass top and sliding doors. Ramp to existing level at 1:21
- 20 New door formed in existing centre window as per Bay 2
- 21 New entry ramp at 1:21 slope
- 22 Steps to new entry landing
- 23 For evacuation & occasional use only

Proposed Reader's Seats = 86

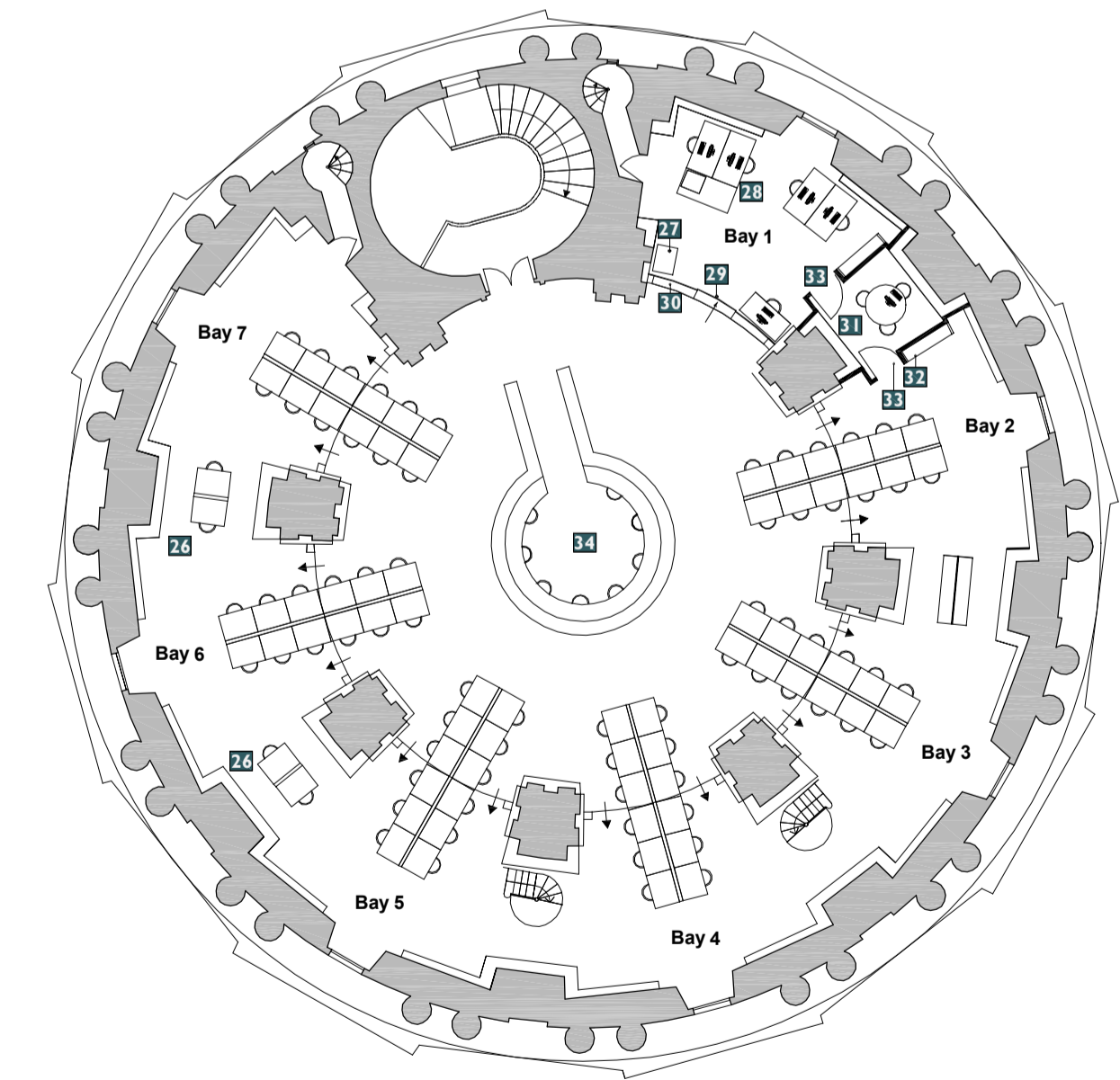

Proposed works

- 26 New Carrel Desks in place of low bookshelves
- 27 Staff photocopyer
- 28 New workstations within new office
- 29 New partition with sliding door
- 30 Bookcase of height 1100mm
- 31 Consultation Space
- 32 New timber panelled partition with bookcase
- 33 Lift Door
- 34 Additional readers seats / look up terminals

Proposed Reader's Seats = 72

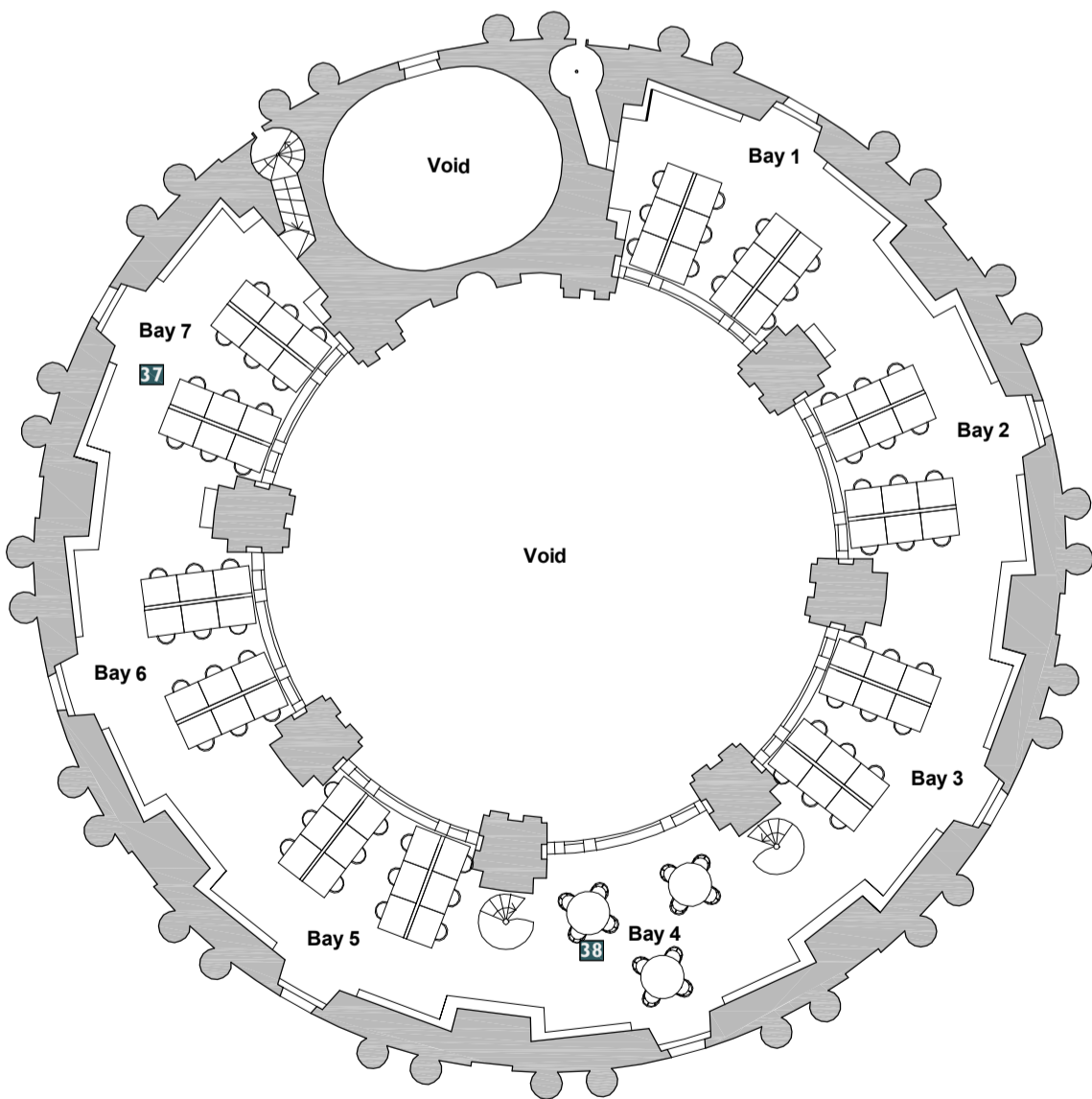

Proposed works

- 37 Existing desks relocated from Bay 4
- 38 Existing refurbished table relocated from Bay 7

Proposed Reader's Seats = 84

LOWER CAMERA

UPPER CAMERA

UPPER GALLERY



LOWER CAMERA - NEW ACCESS

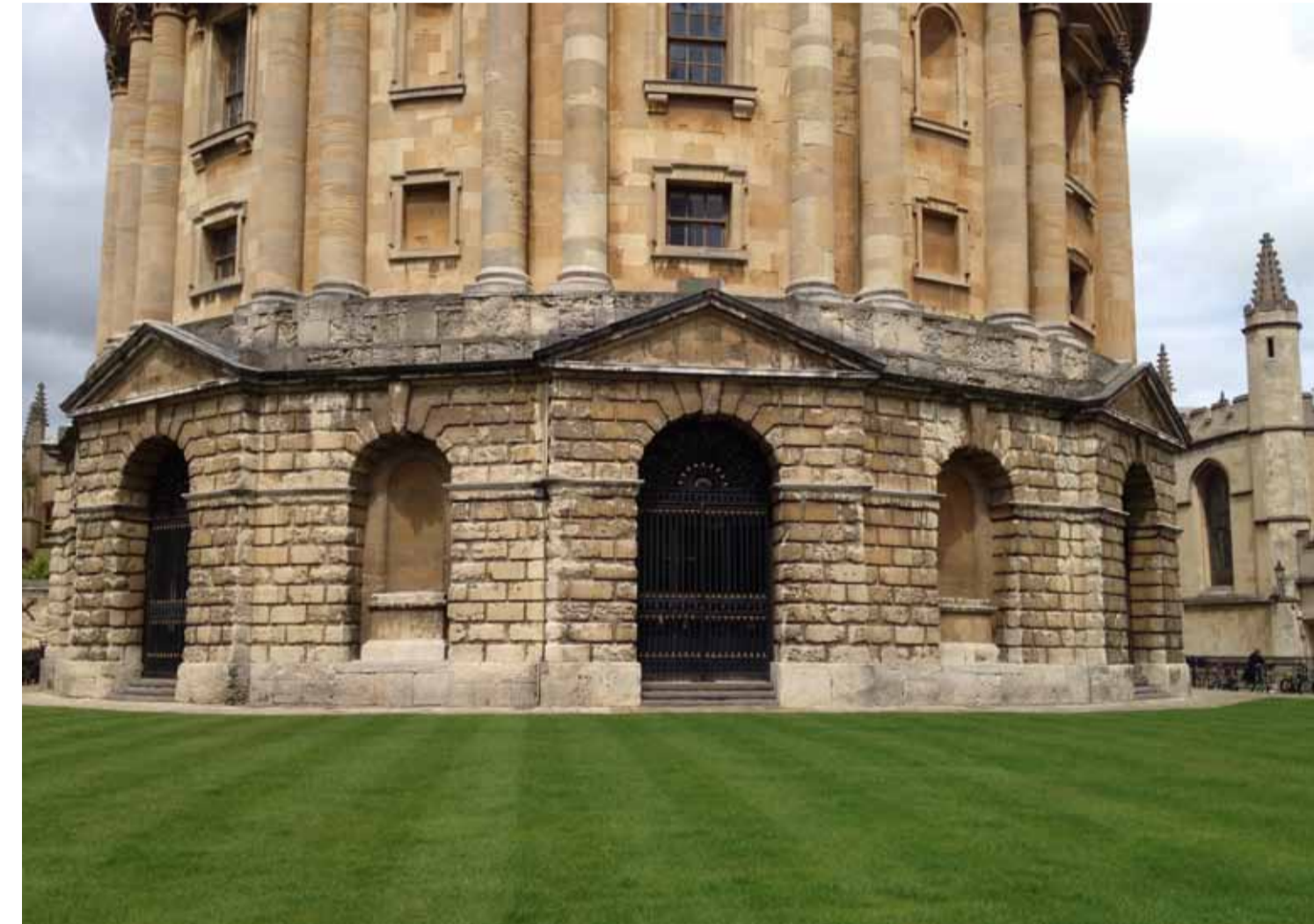
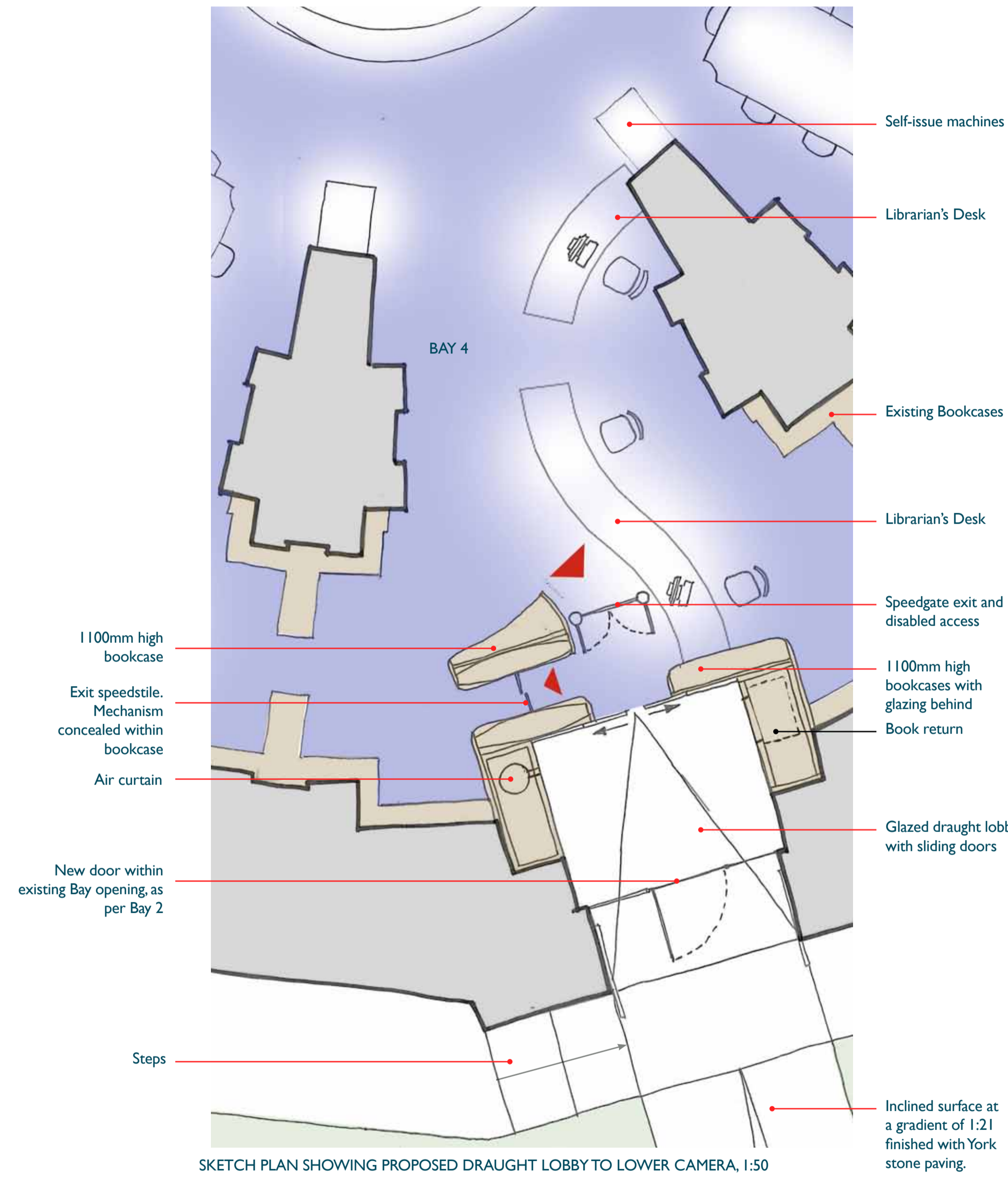

EXISTING SOUTH WINDOW

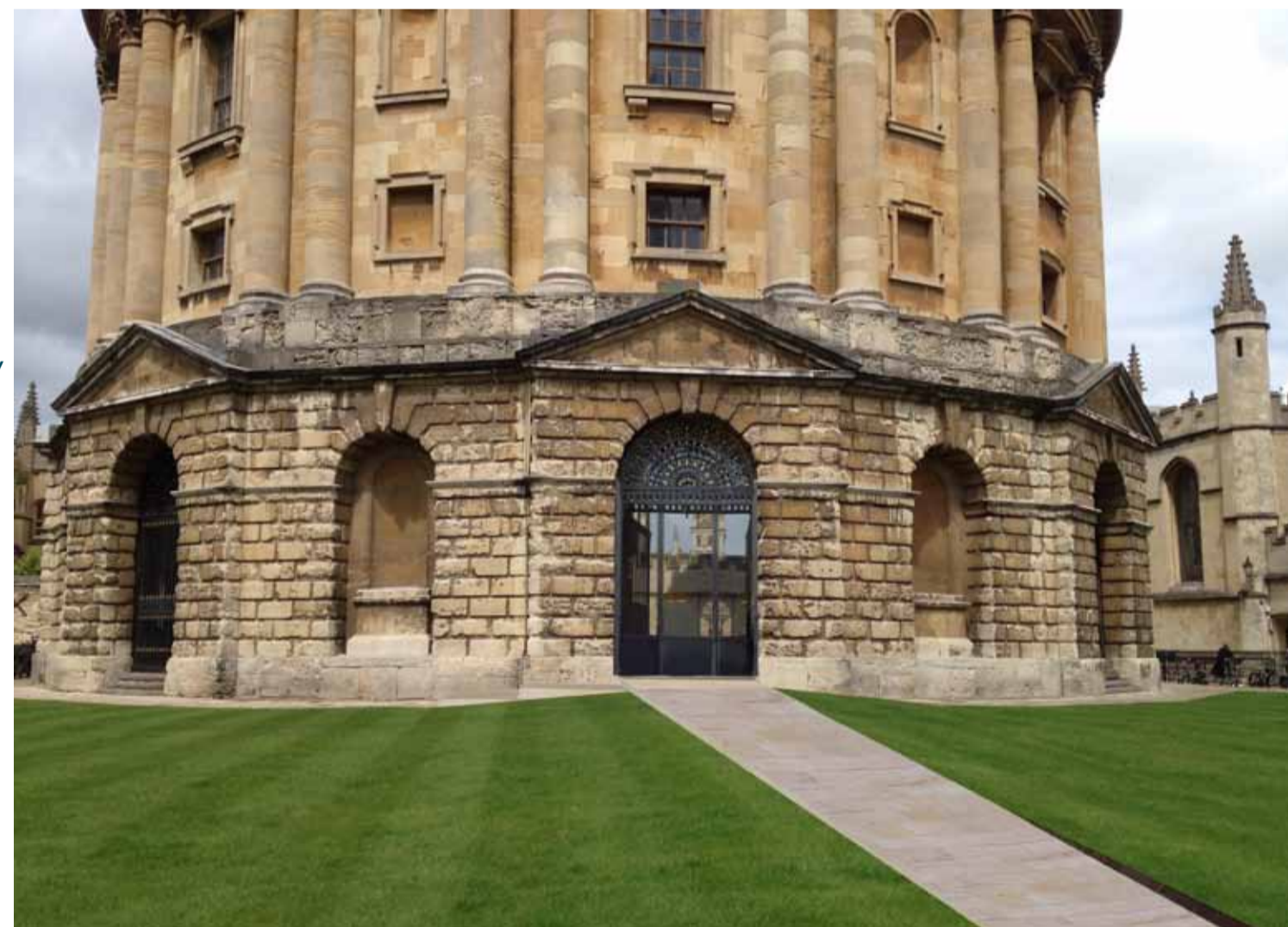

PHOTO MONTAGE - PROPOSED NEW ACCESS



INTERIOR VIEW - EXISTING



SKETCH PERSPECTIVE OF PROPOSED DRAUGHT LOBBY

New access

It must be an intrinsic part of the proposal to create a new entry/exit point. This will provide direct wheelchair access to the Lower Camera reading room and fully compliant fire exit arrangements for these and other people with restricted mobility.

Externally, the York stone paving pattern already provides level access up to the railing. A new gate in front of St Mary's Church will have to be inserted into the existing railing. An inclined surface will provide an inclusive approach to the new door created in the south window of the Lower Camera. The gates and walkway would be similar to the existing approach to the north side.

With increased opening hours and higher levels of use for a slightly broader range of library services, it is deemed essential to resolve the access control and book security difficulties which have become an increasing source of private and public criticism. Creation of a new main entry/exit point in one of the existing openings of the Lower Camera would form the basis of a complete solution to these problems.

Design

The new draught lobby uses the existing opening within the Camera to allow a new and improved access into the Camera. The existing geometry within the Camera is a series of linear shapes within an overall circular structure. The curved desk is in keeping with the existing central desk and has been designed to facilitate movement from the Central Reserve through to the new entrance/exit.

Similar to the design of the new partition to the librarian service point within the Upper Camera, the draught lobby mainly consists of glazing with bookcases at lower level. Glass causes minimum intrusion to the existing elevation of the Camera whilst allowing substantial daylight to filter in to the interior space and leaving the existing arched window unobstructed as in the other bays.



EXISTING PORTER'S DESK TO BE REMOVED

UPPER CAMERA - IMPROVED LIBRARY SERVICES

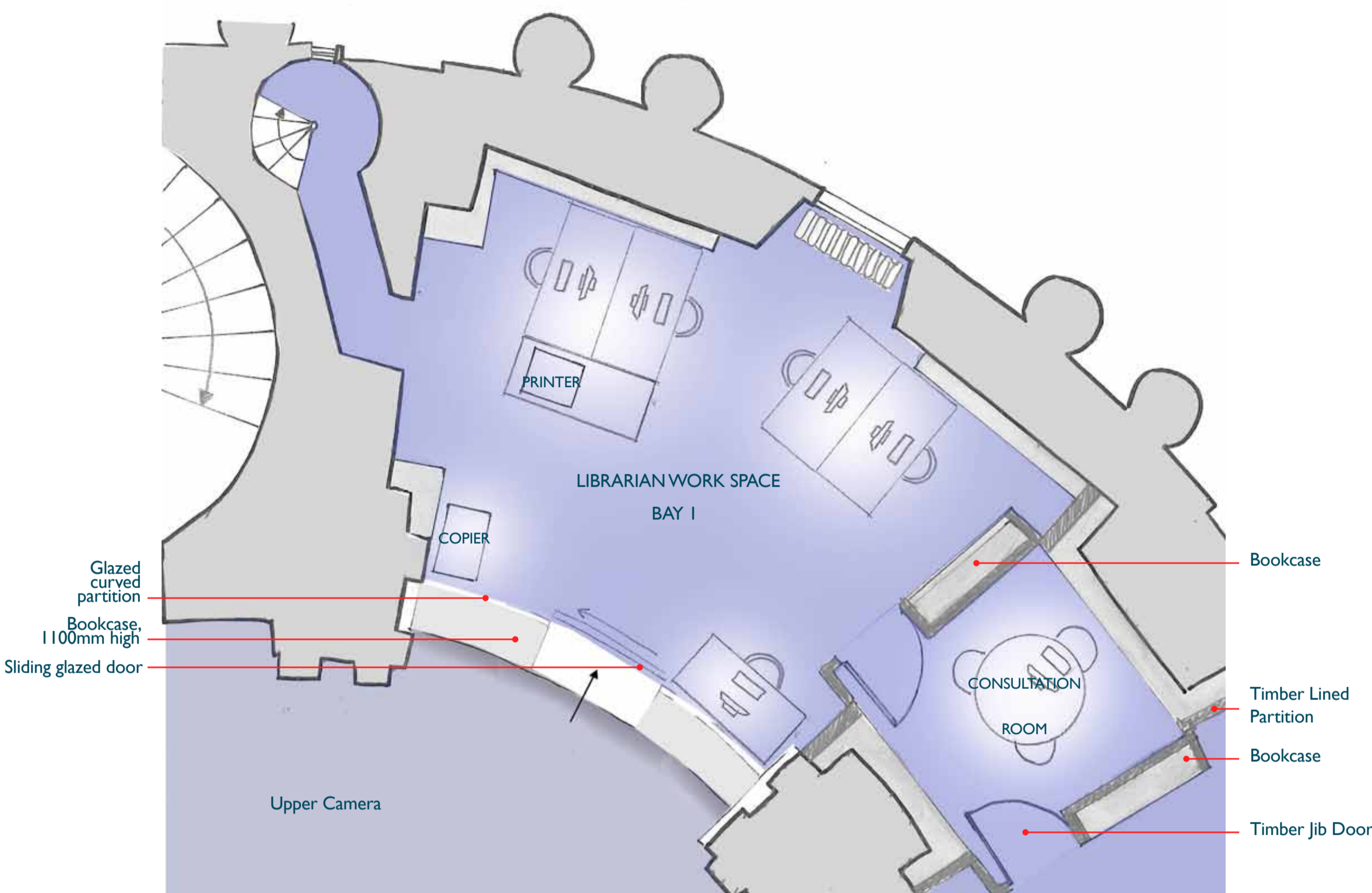

SKETCH PLAN SHOWING PROPOSED OFFICE AREA TO UPPER CAMERA, 1:50

Location of History Information Services Team in the Upper Camera

The History Information Services Team forms the core group of staff being moved from the Old Indian Institute building to the Radcliffe Camera along with relevant lending and core course reference provision. The latter will sit alongside the existing non-lending provision for History students which is already in the Upper Camera and this combined collection will be the focus of the subject support work and service provided by these members of staff. By dint of being in the room, they will also be able to provide the function of invigilation, including assistance with evacuation.

As the space has already been used as a staff area, we feel it is appropriate to continue this use under the new arrangements. Moreover, because of the configuration of seating and shelving in the building we feel that it would be far less appropriate to place these members of staff in the Lower Camera as this would further reduce the amount of reader seating available in a space which already experiences pressure from readers. Conversely the Upper Camera does not need additional reader seating as it already has by far the greater proportion. Situating the staff in the Gladstone Link would be problematic for various reasons. Quite apart from being much further away from the material and associated readers that they will be serving, these members of staff would be in an underground space with no natural light.



VIEW LOOKING INTO BAY 3



VIEW LOOKING INTO BAY 1



VIEW OF BAY 1 FROM THE UPPER GALLERY

Appearance from Central Reserve

Bay 1 of the Upper Camera is currently used as a librarian work station, processing and storage area. Out of the 7 Bays within the Upper Camera it is the only one where the window is hidden behind an existing bookcase of modern construction. Bay 3 (above) is a typical view of each of the other bays looking from the centre of the Camera. By opening up the space and replacing the existing counter with a glazed partition, the existing window of Bay 1 can be seen from the centre of the room. As well as looking better aesthetically more light is admitted into the central Camera. This enhances the current learning environment whilst transforming the space closer to how it originally would have been experienced.

Access from the central area into Bay 1 would be through a sliding glass door within the proposed glazed partition. The partition provides acoustic separation between the main study area and office space. Visually the division of this partition will be very subtle, achieved by using frameless glass. The door has also been positioned centrally to relate to the proportions of the existing building and the window behind. Low bookcases will be positioned in front of the glazed partition to provide storage as a compromise to bookcases being removed. The bookcases would not be fixed to the partition allowing for maximum versatility in the future.

Proposed layout

The proposed layout retains existing bookcases around the edge of the room whilst removing the newer bookcase down the centre of the room. This creates a more open space which overlooks the rest of the Upper Camera. A Consultation Area for private discussion is accessed from Bay 1 and Bay 2.

Appearance from Bay 2

The Consultation Area will be enclosed by 2 new bookcases that are within the new stud partitions. As well as creating additional storage space, this design approach is sympathetic to the existing features. Jib doors appear 'hidden' in the new partition and are in keeping with the existing materials and aesthetic within the Radcliffe Camera. A frameless glass bulkhead will maintain the visibility of the decorative plaster work on the ceiling.



VIEW FROM BAY 2 LOOKING TOWARDS BAY 1



OLD BODLEIAN - CONSOLIDATION OF SERVICE POINTS

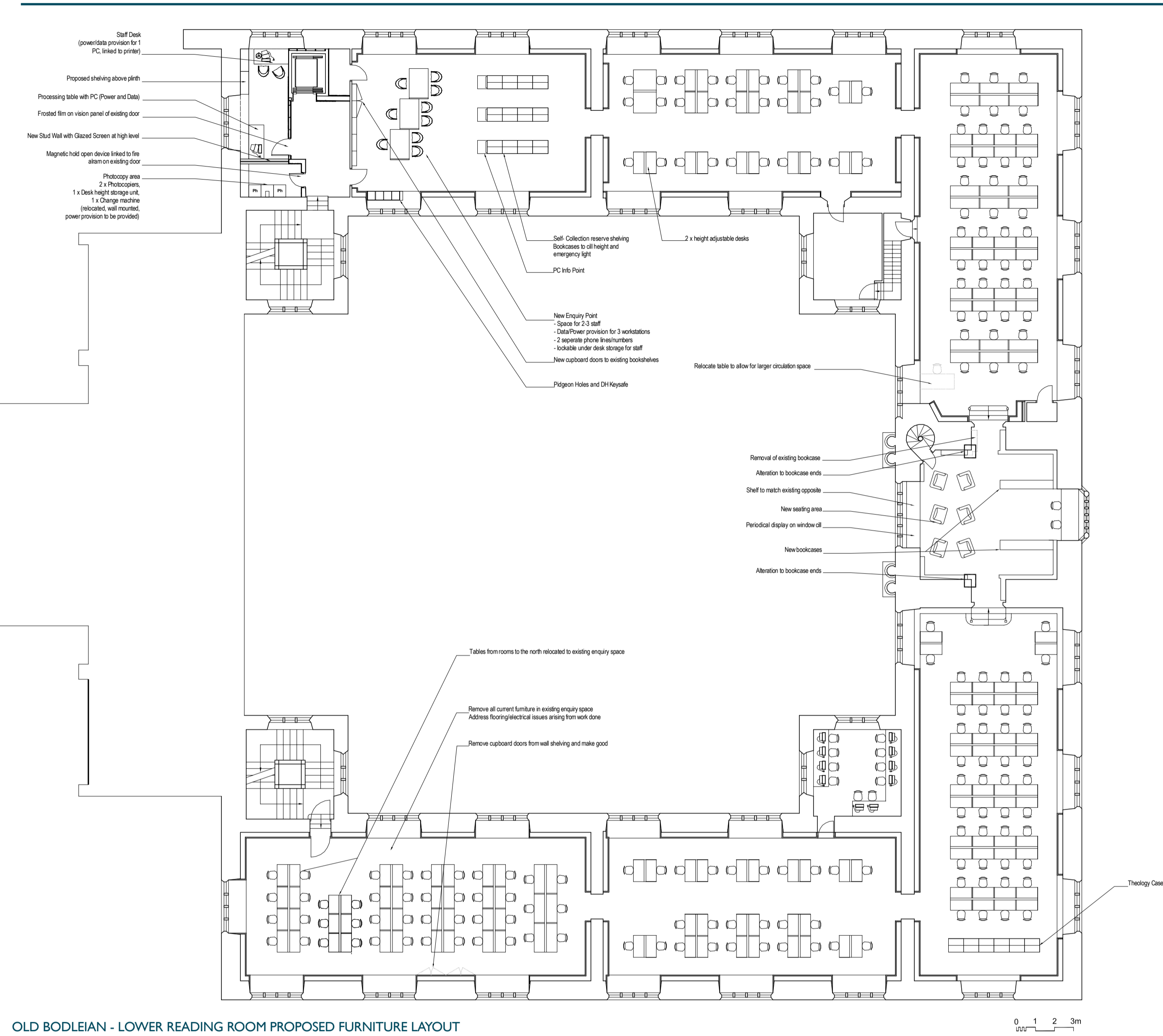

OLD BODLEIAN - LOWER READING ROOM PROPOSED FURNITURE LAYOUT

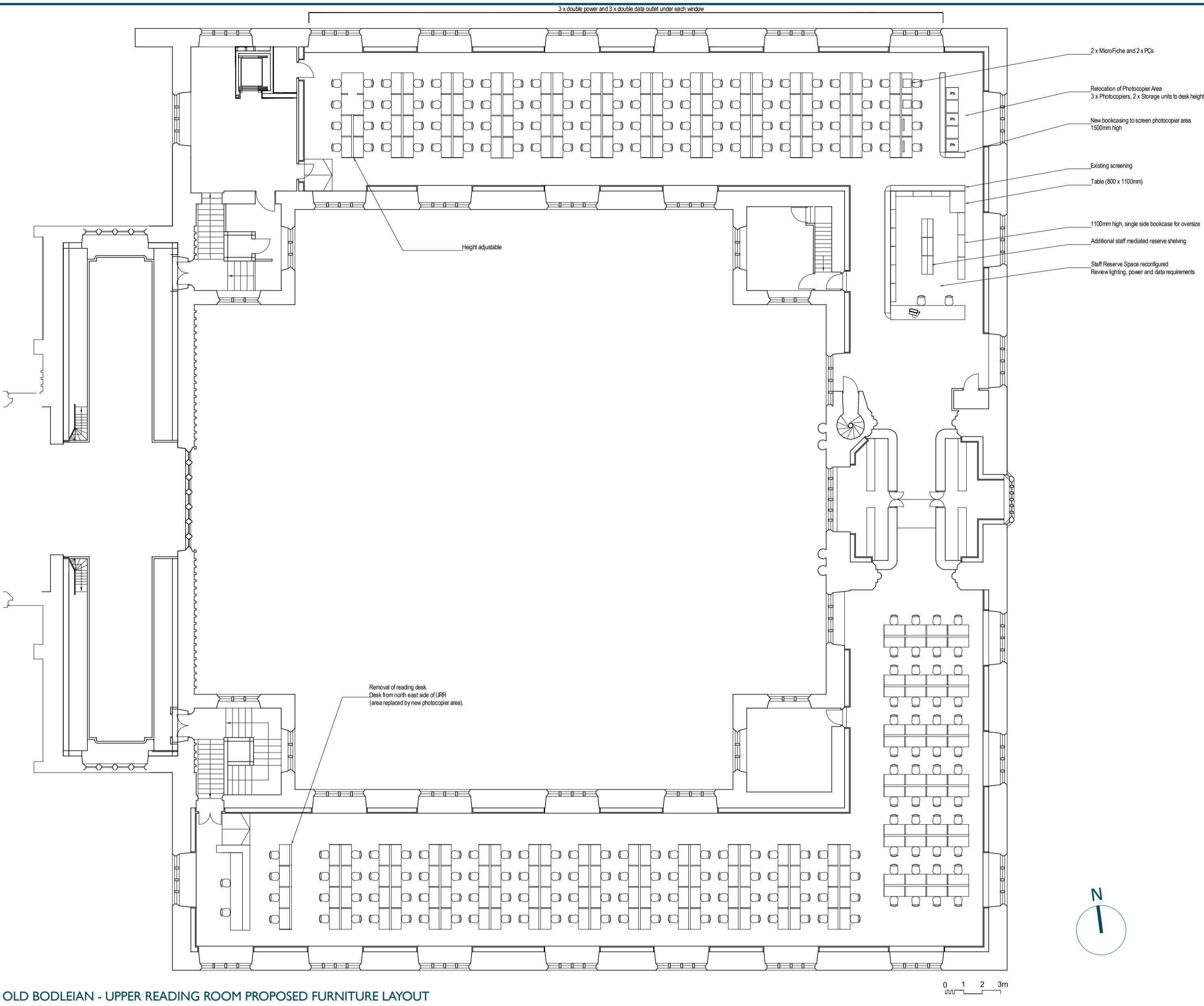

OLD BODLEIAN - UPPER READING ROOM PROPOSED FURNITURE LAYOUT

Old Bodleian Library

The reading rooms of the Old Bodleian Library are some of the finest in the world and the current proposals represent a modest rearrangement of furniture to consolidate existing multiple service points. On each floor, the opportunity is also being taken to locate the single service point in an area which is accessible to people of restricted mobility (who are now able to use the lift which was installed in 2011). Currently the service point on the Lower Reading Room is located above the main gate and is accessible only through a set of stairs. We also plan to increase the number of reader seats in the Lower Reading Room by up to 20.

Configuration of services

The arrangement of subjects within the reading rooms of the Old Bodleian Library and Radcliffe Camera has been developed with the relevant Faculties during a period of consultation. The core elements of the proposal are for non-lending/reference and lending materials for undergraduates in History and non-lending/materials for undergraduates in English to be situated in the Radcliffe Camera and the adjacent end of the Gladstone Link. Unitary undergraduate and research provision in Classics, Philosophy and Patristics in the Lower Reading Room will be joined by similar provision for Theology. Research provision for English and History in the Upper Reading Room will remain the same in broad outline though the selection of open-shelf material will change. The provision for Linguistics will move to the Taylor Institution in accordance with the outcome of a separate consultation exercise which has just been completed.

Alongside the revised arrangement of subjects the opportunity will also be taken to revise the provision of reader services within the reading rooms. This continues the work of the Old Bodleian Access Project, of which other elements were carried out in 2010 and 2011. The aim is to introduce various elements of self service ('self collection' of items requested from the Book Storage Facility, self-issue of lending material), to reduce the number of staffed 'reserves' from four to two, and to consolidate all main services (enquiries, help, etc) in one location in each building.

EXISTING: FIRST FLOOR



LOWER READING ROOMS



RESERVE AREA TO BE RECONFIGURED



RESERVE AREA TO BE RECONFIGURED

EXISTING: SECOND FLOOR



UPPER READING ROOMS



ENQUIRY AREA TO BE RELOCATED



PHOTOCOPY AREA TO BE RECONFIGURED

HERITAGE IMPACT TABLE AND PROGRAMME



1.0 Significance of the Bodleian Library, its Collections and Reader Functions						
Item No.	Description/ Area Affected	Date	Level of Significance	Code	Proposals	Impact
1.1	The Bodleian Libraries	15 th C onwards	High	Refer to Plan / Sections on Boards no. 1 - 2 - 3 - 4 - 5	Improve the standards of library provision by the refurbishment and reorganisation of these areas to improve reader services, staff operation and transportation standards, thereby maintaining the international reputation of the Bodleian Library	High beneficial
1.2	Whole study area	16 th C onwards	High	Refer to Plan / Sections on Boards no. 1 - 2 - 3 - 4 - 5	Increase accessibility and implement Equality Act standards by the provision of level access and, thereby allowing more people to freely use the buildings	High beneficial
2.0 Individual Elements: Lower Camera						
Item No.	Description/ Area Affected	Date	Level of Significance	Code (Refer to Plans on Board no. 2)	Proposals	Impact
2.1	Metal platform and stair to form the Porter's desk in the main staircase	1996	Intrusive	11	Remove the highly intrusive platform and stair to leave the view of the main stone staircase and metal railing unobstructed	High beneficial
2.2	Stone walls and ceiling of Lower Reading Room	1737-49	High		These will be unaffected	Neutral
2.3	Book detectors and access control gates	2011	Intrusive	21 31	Remove the security access arrangement from the arch leading to the existing access to the staircase	High beneficial
2.4	Processing table in bay 2	2011	Low	41 11	Remove of contemporary loose furniture to allow room for 2nr, new readers' desks	Low beneficial
2.5	Readers' desk in bay 4	1940	Low	51 13 17 18 19	Remove of readers' desk to allow room for the new inclusive access arrangement and improved Library services. The redundant desk will be kept safe in one of the University storages until an appropriate re-use is found. The loss of readers' seats will be recovered by introducing new readers' workstations. Please refer to the plans on board no.2	Neutral
2.6	Bookshelves in bay 4 of the Lower Camera	1860's	Moderate	61 12	Alteration to the end panels of the bookcases in Bay 4 in order to integrate them in the new entrance construction. The original bookcases were altered substantially in 1946 and subsequently adapted to different needs	Neutral
2.7	Floor construction of bay 4 of Lower Camera	1860's	Low	71 12	Alteration to a section of the raised timber floor to incorporate the new entrance construction	Neutral
2.8	Lower Camera window frame in Bay 4	1959	Low	81 20	One of these mid 20 th C window frames, in bay 4, is proposed to be opened to create the new main access	Neutral
2.9	Decorative metal grilles/gates	1737-49	High	81 20	The gates in bay 4 will be unlocked to allow access through. This will re-instate the original purpose of this opening	Neutral
2.10	Standing height desk in centre Lower Camera	1940	Low	91 10	A section of the standing desk will be lowered to create 2nr. additional readers' seats	Neutral
3.0 Individual Elements: Upper Camera						
Item No.	Description/ Area Affected	Date	Level of Significance	Code (Refer to Plans on Board no. 2)	Proposals	Impact
3.1	Central Bookcase and issue desk in bay 1	1969	Intrusive	24 21 23	Removal of the modern furniture in bay 1 to reveal the window and the original bookcases characterising the view of all the bays from the central area	High beneficial
3.2	Joinery work around the bay 1 opening	1743-1749	High	24 23 30	This will be unaffected as the new frameless glass screen will be set out behind the original timber linings and decorations	Neutral
3.3	Timber bookcases along the walls and central structure	1743-1749	High	31 32 33	These will be unaffected as the new construction will not alter the original construction	Neutral
3.4	Low bookcases in between bays 5-6 and 6-7	1969	Low	25 22	Removal of the modern furniture to allow room for additional readers' carrel workstation	Neutral
4.0 Individual Elements: Upper Gallery						
Item No.	Description/ Area Affected	Date	Level of Significance	Code (Refer to Plans on Board no. 2)	Proposals	Impact
4.1	Readers' desks in bay 7	1969	Low	35 37	The desks will be relocated to bay 7 which is currently used as storage. This will create a lesser cluttered area in bay 4 where the 2nr. metal spiral stairs are located	Low beneficial
4.2	Partition between bays 6-7	1935?	Intrusive	36 37	The partition and door will be removed to re-instate the original plan form of the Upper Gallery	Moderate beneficial
5.0 Individual Elements: Bodleian Library Lower and Upper Reading Rooms						
Item No.	Description/ Area Affected	Date	Level of Significance	Code	Proposals	Impact
5.1	Existing readers' desks and reserve areas	1937-1940	Low	Refer to Plans on Board no. 5	The furniture position will be rationalised to allow the creation of 2nr. Service Points in highly accessible locations, increase the seating capacity and update the power/data provision in a few locations	Moderate beneficial
5.2	Storage room on the 1 st Floor of the North West Tower	2011	Low	Refer to Plans on Board no. 5	The storage area will be subdivided in two smaller rooms providing a photocopier room away from the Reading Rooms and staff office	Neutral
6.0 Individual Elements: Radcliffe Square						
Item No.	Description/ Area Affected	Date	Level of Significance	Code	Proposals	Impact
6.1	Stone steps up to arched openings	1737-49	Moderate	Refer to Plans / Sections on Boards no. 1 - 2	Two of the external stone steps into bay 4 will be affected as the walkway from new gate in the railings will ramp on a very gentle gradient to take visitors up to the top step.	Low adverse to achieve level access
6.2	Stone paving around Camera	Possibly 1827 or 1936, extended 1993	Moderate	Refer to Plans / Sections on Boards no. 1 - 2	A small section of the stone paving around the Camera will be affected as it will be covered by the stone walkway discussed above in 6.1	Low adverse to achieve level access
6.3	South lawn	1827, altered 1936	Moderate	Refer to Plan / Sections on Board no. 1	The South lawn will be centrally cut in two equal sizes as the ramp discussed above in 6.1 will take visitors from the gate in the railings to the new door in bay 4. The lawn layout will be similar to the one on the North lawn of Radcliffe Square	Neutral
6.4	Metal railings	1993	Low	Refer to Plan / Sections on Board no. 1	Two of the railing panels will have to be removed to create a new gate with stone piers to match the existing one on the North side.	Neutral
7.0 External Views and Setting						
Item No.	Description/ Area Affected	Date	Level of Significance	Code	Proposals	Impact
7.1	Radcliffe Square	1737-49 (Camera), 19 th C (lawns), 20 th C (paving, railings and cobbles)	High	Refer to Plan / Sections on Board no. 1	The Square will be slightly affected with the insertion of a new gate and walk to the South opening of the Camera but will retain its character intact. Although the main access to the Camera will be place on the opposite side of the Square, it will maintain the axial route connecting the Bodleian buildings and St. Mary's	Neutral
8.0 Temporary Impact during Construction						
Item No.	Description/ Area Affected	Date	Level of Significance	Code	Proposals	Impact
8.1	Radcliffe Camera	1737-49	High	Refer to Plan / Sections on Boards no. 1 - 2 - 3 - 4	The works will be phased to mitigate the disruptions caused during construction therefore temporary fencing/enclosure will be created to isolate the building environment. This will be only for the duration of the works.	Low adverse (temporary)
8.2	Radcliffe Square	1737-49 (Camera), 19 th C (lawns), 20 th C (paving, railings and cobbles)	High	Refer to Plan / Sections on Board no. 1	Site enclosure using fencing will be needed on the South lawn and some minor groundwork to create the new stone walkway	Moderate adverse (temporary)
8.3	Whole site	From 15 th C onwards	High	Refer to Plan / Sections on Board no. 1	Construction traffic particularly in Radcliffe Square, the Schools Quadrangle and Catte Street	Moderate adverse (temporary)
8.4	Old Bodleian	1613-18	High	Refer to Plans on Board no. 5	The works are of minor scale as they are mainly related to the furniture re-location. Accurate phasing of this element should mitigate any impact on the building and its fruition	Neutral

Programme

Planning / LBC Submission	Late June
Works to Old Bodleian Reading Rooms	Summer
Planning / LBC Consent	Early September
Works to Radcliffe Camera	September 2012
Completion of Works	Michaelmas Term 2012



Next Steps....

We welcome your views on the plans that have been presented. Please feel free to complete a feedback form.

Once this exhibition has ended we will review all the comments we have received and finalise the planning applications which will be submitted to Oxford City Council in the coming weeks. In addition to this consultation exercise, Oxford City Council will undertake a statutory consultation once both applications have been lodged with a view to determining the application later this year.

The planning and listed building consent applications for the proposals will comprise the following productions:

- Full technical and Architectural Drawings
- Design and Access Statement
- Heritage Impact Assessment
- Construction Methodology
- Mechanical and Electrical Services Statement
- Planning Statement
- Statement of Community Consultation

The Conservation Management Plan for the Radcliffe Camera is available on:

<http://www.admin.ox.ac.uk/estates/conservation/conservationmanagementplans/>

For more information please visit the following website:

www.bodleian.ox.ac.uk

Thank you for attending our exhibition.